

TOP VIEW

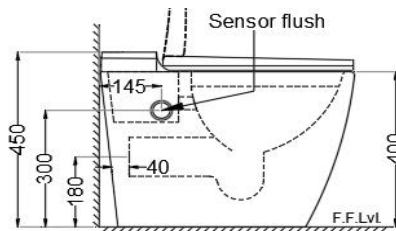

SIDE VIEW

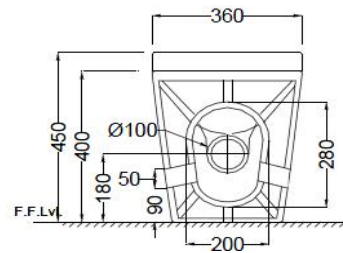

BACK VIEW

General Information

Product Code	OPS-WHT-15851P180UFSMTL
Brand	Jaquar
Colour	White
Type	Tankless Single Piece WC (P Trap)
Material	Ceramic - Vitreous China

Product Specification

Product Dimension	360x580x450 mm
Basin Inner Dimension	270X330 mm
Product Net Weight	33 kg.
Product Gross Weight	39 kg
Packaging Dimension	630x490x500 mm
Outlet	Vertical
Waste Hole Dimension	External diameter of outlet hole dia. $\varnothing 100 \pm 5$ mm
Waste Hole Distance	Vertical distance between the Floor and the center line of the waste outlet hole ≤ 180 mm
Product Features	Tankless floor mounted WC with Sensor And Manual flush @ 4.5 LPF, Anti germ glaze, Jet associated flush, IP Rating - IP68, Trap distance-180 mm, Sensor range-180 mm, UF seat cover and Angle Valve.

ACCESSORIES INCLUDED

UF Soft Close Seat cover	OPS-WHT-15107UF
Angle Valve	ZPS-WHT-TL008
Floor Fixing Screw	ZPS-SNS-FB02

CARE AND CLEANING GUIDELINES

- Vitreous china sanitary ware products are fragile in nature and need to be handled with care (to avoid personal injury) at all times during its storage, handling, installation and use thereafter.
- The product is heavy and it is recommended that two persons hold it while it is being fixed.
- Carefully inspect the new product for damage before installation.
- Risk of product damage. Over tightening may cause breakage or chipping of vitreous china.
- Risk of external leakage. Do not lift or rock the bowl after placement.
- Always test your cleaning solution on an inconspicuous area on the product before applying it to the entire surface.
- Do not allow cleaners to sit or soak on the product.
- Use a soft, dampened sponge or cloth to clean. Never use abrasive material like a bristle brush or scouring pad.
- Wipe surfaces clean and rinse completely with water immediately after applying cleaners.
- Clean Chrome, stainless steel surfaces once a week. Do not use cleaners containing chloride on chrome, stainless steel. If used, rinse the surface immediately to prevent corrosion.
- Wherever chrome plating is used on the products, use only warm water to clean and then dry with a soft cloth.

QUALITY MANAGEMENT SYSTEM - ISO 9001



DISCLAIMER: Our every effort has been made to ensure factual accuracy, the information presented subject to changes due to requirements in different sites, markets and/or countries. All dimensions are in mm (Tolerance ± 5 MM). Jaquar reserves the right to make the necessary amendments at any time without prior notice.

For Installation Refer Actual Product